

Angular Contact Ball Bearings

Brass cage angular contact ball bearing-7210 BECBP

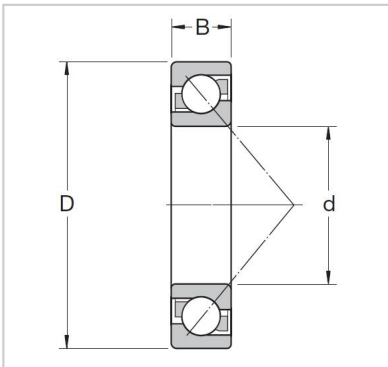

Abutment and fillet dimensions

Db max.	7210 BECBP
Da max.	-
da min.	50
rb max.	90
ra max.	20

Dimensions

a	40
r3,4 min.	31
r1,2 min	1.32
D1	9 000
d2	9 000
d1	0.47

Mass

KG	65.8
----	------

Speed ratings r/min

Limiting speed	57.7
Reference speed	75.2

Fatigue load limit

Pu kN	1.1
-------	-----

Basic load ratings KN

dynamic C kN	0.6
static Co kN	39

Basic design bearing

B mm	57
D mm	83
d mm	85.8

Basic design bearing

Universally matchable bearing	1 0.6
-------------------------------	--------------